

Massive

Chris van Uffelen

Brutalism Now and Then

Expressive



Sculptural



BRAUN

**INTRODUCTION Brutalism
Now and Then 10 /**

**MATERIAL AS FOUND 12 /
Concrete House in Füllins-
dorf by Wespi de Meuron
Romeo Architects 22 / CCC
Gallery by Fránek Archi-
tects 26 / Wotruba Church
by Fritz Wotruba 30 / Holy
Redeemer Church by Menis
Arquitectos 32 / House 6 Menlo Park by
Cheng Design 36 / Trellick Tower by Erno
Goldfinger 40 / BB House by BAK arqui-
tectos 42 / Volcano Park Visitor Center by
Foldes Architects 48 / National Library by
Clorindo Testa, Francisco Bullrich, Alicia
Cazzaniga 52 / MeCrì Museum Pavilion by
studio inches architettura 54 / Residence 2
at Alibaug by Malik Architecture 58 / SESC
Pompéia by Lina Bo
Bardi 62 / Coventry
Cathedral by Basil
Spence 64 /**

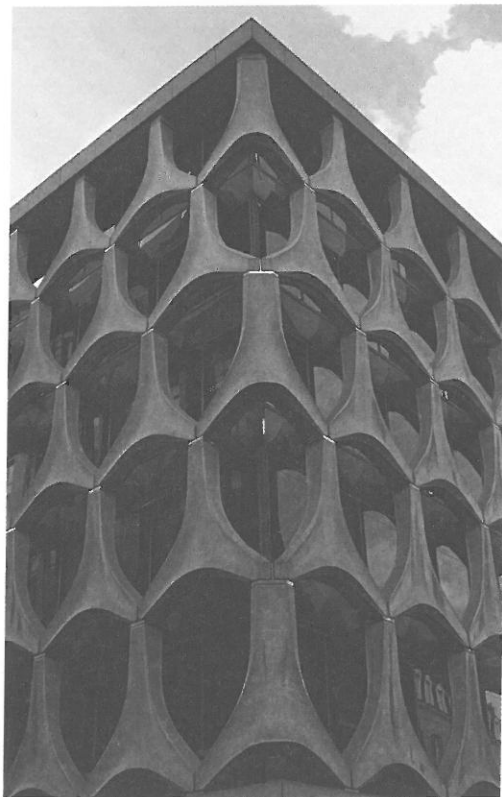

**BUILDING IMAGES 66 / Two Moon by
Moon Hoon 76 / Rorschach Elevator by
Alex Buob 80 / Solomon R. Guggenheim
Museum by Frank Lloyd Wright 84 / Honda
Big Wing by Vaslab 86 / Mary Queen of
Peace by Gottfried Böhm 90 / B14 in Ice-
land by Studio Granda 92 / Marina City
by Bertrand
Goldberg 96 /
Church of
Seed by O
Studio Ar-
chitects 98 /
National Con-
gress of Brazil
by Oscar Niemeyer 102 / House in the
Orchard by Šépká Architekti 104 / The
Lord's Ark Church by Wojciech Pietrzyk
and Jan Grabacki 108 / UNESCO Headquar-
ters by Marcel Breuer, Pier Luigi Nervi,
Antonio Nervi, Bernard Zehruss 110 /
Hydroelectric Power Station Winnebach
by monovolume architecture+design 112 /
Liverpool Metropolitan Cathedral by**



Frederick Gibberd ¹¹⁶ / **Sun Path House** by **Studio Christian Wassmann** ¹¹⁸ /

LEGIBILITY OF PLAN ¹²⁴ / **Maria-Magdalena Church** by **kister scheithauer gross architekten und stadtplaner (ksg)** ¹³² / **Habitat 67** by **Moshe Safdie** ¹³⁶ / **Sea-**



shore Library by **Vector Architects** ¹³⁸ / **Horta Vermella Nursery School** by **Colomer-Aceves Arquitectes** ¹⁴² / **Salk Institute for Biolog-**

ical Studies by **Louis I. Kahn** ¹⁴⁶ / **Braunschweig Residence** by **Nieberg Architect atelieraxelnieberg** ¹⁴⁸ / **Caisse d'Epargne Mériadeck** by **Edmond Lay, Pierre Layré-Cassou and Pierre Dugravier** ¹⁵² / **Sunset Chapel** by **Bunker Arquitectura** ¹⁵⁴ / **Numata Elementary School** by **Atelier BNK** ¹⁵⁸ / **Barbican Centre** by **Chamberlin, Powell and Bon** ¹⁶² / **Grube Messel Visitor Center** by **Landau + Kindelbacher**

Architekten Innenarchitekten ¹⁶⁴ / **Faculty of Fine Arts La Laguna University** by **gpy arquitectos** ¹⁶⁸ / **Geisel Library** by **William Pereira** ¹⁷⁴ / **Scout House Hindemosehus** by **Sophus Søbye Architects** ¹⁷⁶ / **La Grande-Motte** by **Jean Balladur** ¹⁸⁰ /

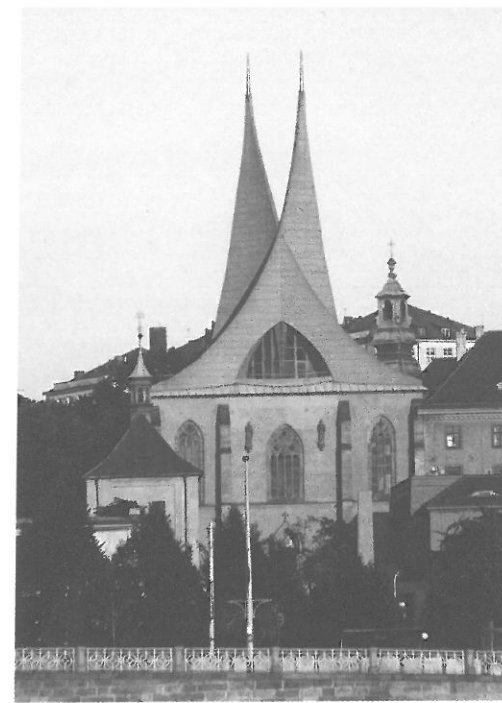

CLEAR STRUCTURE ¹⁸² / **University Campus UTEC Lima** by **Grafton Architects** ¹⁹⁰ / **Economist Building** by **Alison and Peter Smithson** ¹⁹⁴ / **La Cuesta House** by **Agustín Lozada** ¹⁹⁶ / **Mausoleum in Michniów** by **Nizio Design International, Mirosław Nizio** ²⁰⁰ / **Kaiser Wilhelm Memorial Church** by **Egon Eiermann** ²⁰⁴ / **Tower**



House by **banduk smith studio** ²⁰⁶ / **MA House** by **Cadaval & Solà-Morales** ²¹⁰ / **Jewett Arts Center**

**Wellesley College by Paul Rudolph 214 /
Busan Times by Moon Hoon 216 / Robert
C. Weaver Federal Building by Marcel**

**Breuer 222 /
Spring Street
Salt Shed by
Dattner Archi-
tects with WXY
Architecture
+ Urban De-**

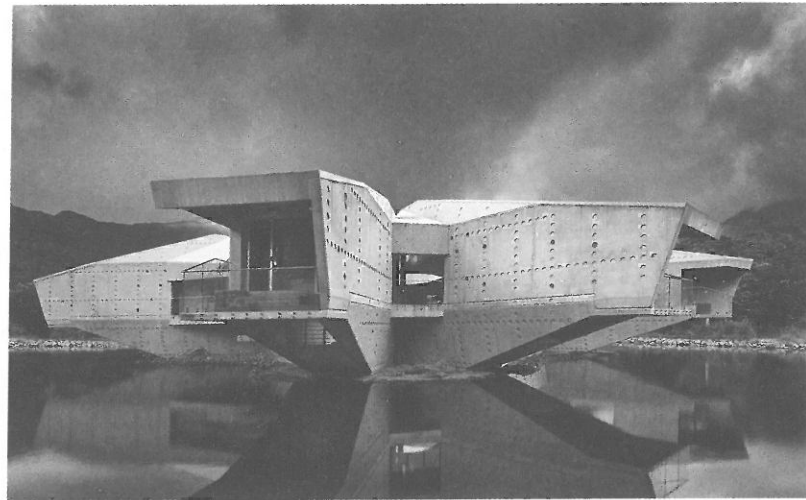

sign 224 / Unité d'Habitation by Le Corbusier 228 / Digital Beijing by Studio Zhu-Pei and Urbanus 230 / Valleaceron Chapel by S-M.A.O. 234 /

**DISPOSITION OF SPACE 238 / Stamp
House by Charles Wright Architects 246 /**



**Two Houses in Santa
Isabel by Bak Gordon
Arquitectos 252 / La
Valletta City Gate by
Renzo Piano Building**

**Workshop 256 / Castelvecchio Museum by
Carlo Scarpa 260 / Green Hills Kinder-**

**garten by Broissin 262 / Cube Houses by
Piet Bloom 266 / Armenia Building by BAK
arquitectos 268 / Jinhua Architecture Park
by DnA_Design And Architecture 272 /
Cabbages of Créteil by Gérard Grand-
val 276 / Guna House by Pezo von Ellrichs-
hausen 278 / Nakagin Capsule Tower by
Kisho Kurokawa 284 / Schengen School**

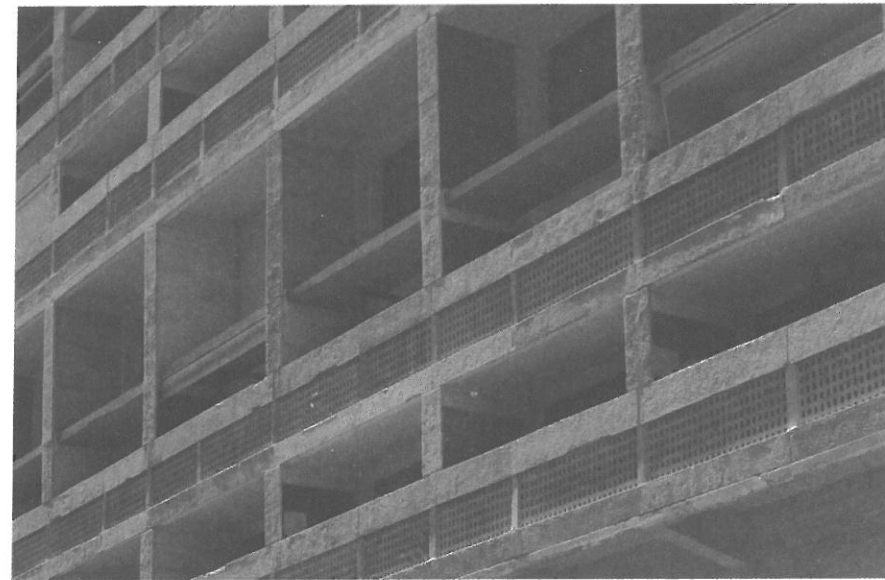

**Complex by
Valentiny
hvp archi-
tects 286 /
House for
Trees by
VTN archi-
tects 290 /**

**CONCLUSION Brutalism Now and Then 294
/ Architects Index 296 / Picture Credits 299 /**

by gpy arquitectos

Faculty of Fine Arts La Laguna University

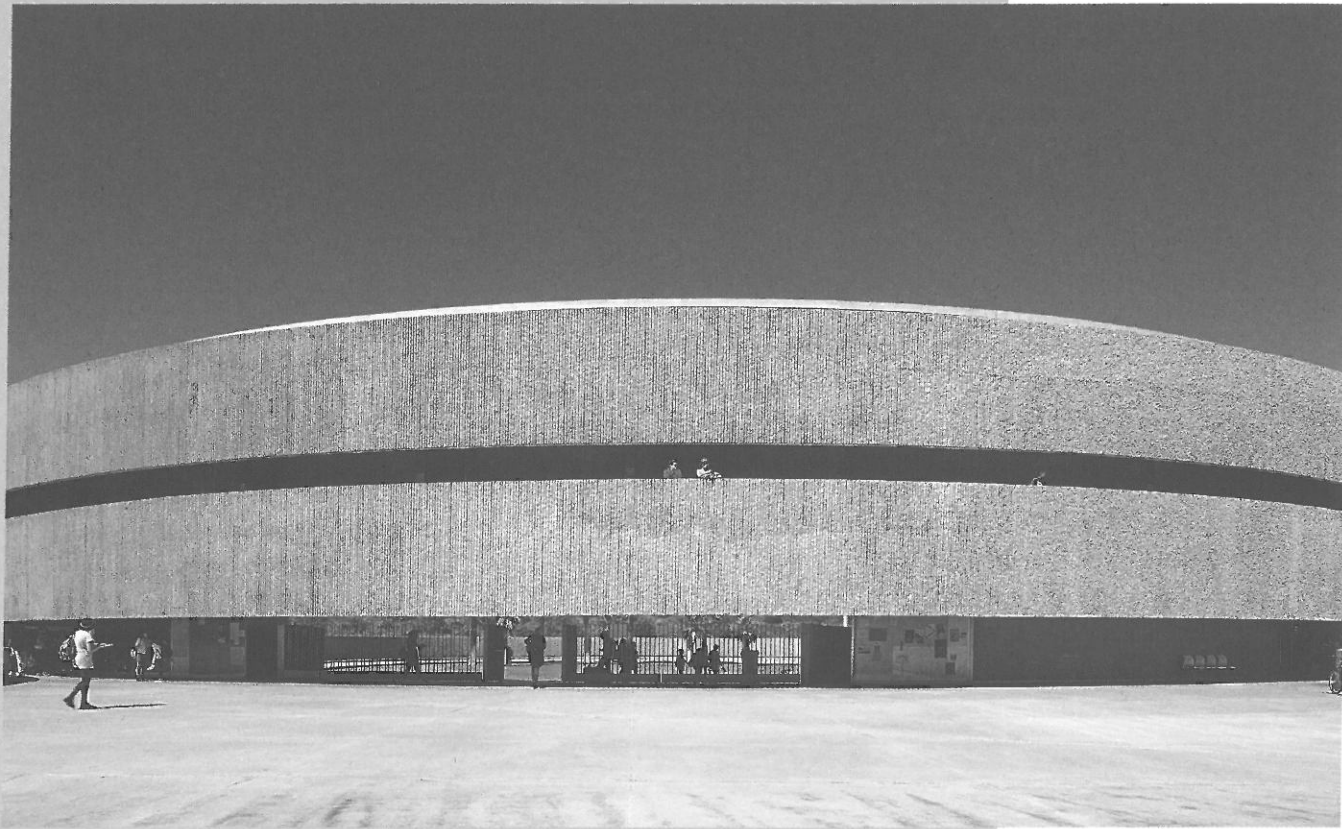

Located in a heterogeneous area, adjacent to the island highway, the new Faculty of Fine Arts building wraps itself around an intimate open space, creating an interior landscape. The building is dominated by structured concrete: a skin of suspended concrete slats adopts a curved shape

Location: La Laguna, Tenerife, Spain
Architect: gpy arquitectos / Juan Antonio González, Urbano Yanes, Constanze Sixt
Year of Completion: 2014

and wraps and protects the interior open space of the building. The concrete skin manifests a dual vocation of scale,

housing the teaching areas, offering flexible and innovative spaces for an experimental education, while at the same time defining the building's urban and territorial image. The space between the concrete skin and a continuous skin of cast glass acts like a filter, separating the spaces of specific uses from the common ones like the patio gardens and open ramps, the covered galleries and the entrance terrace.

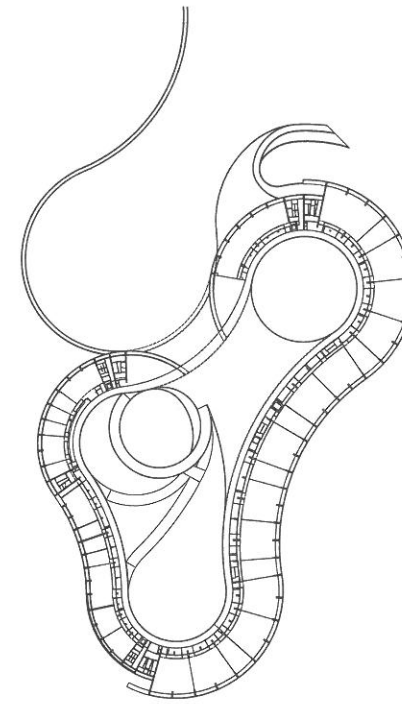

Floor plan of main entrance

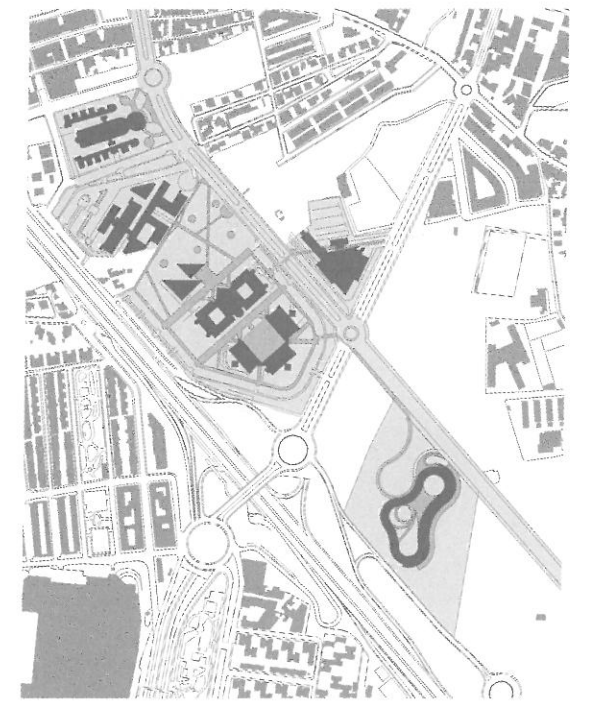

Site plan

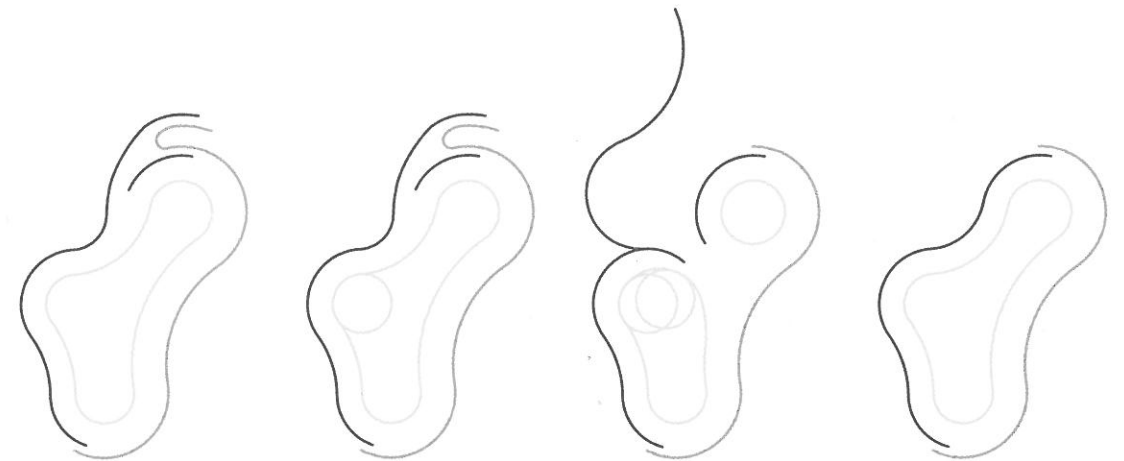

Diagrams of concrete skin (level 1-4)

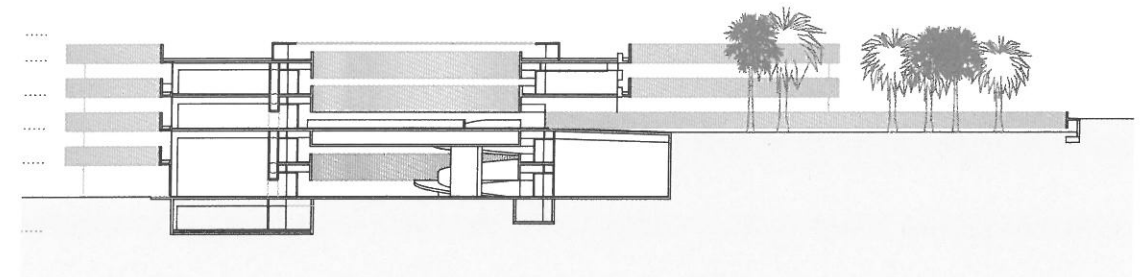

Section

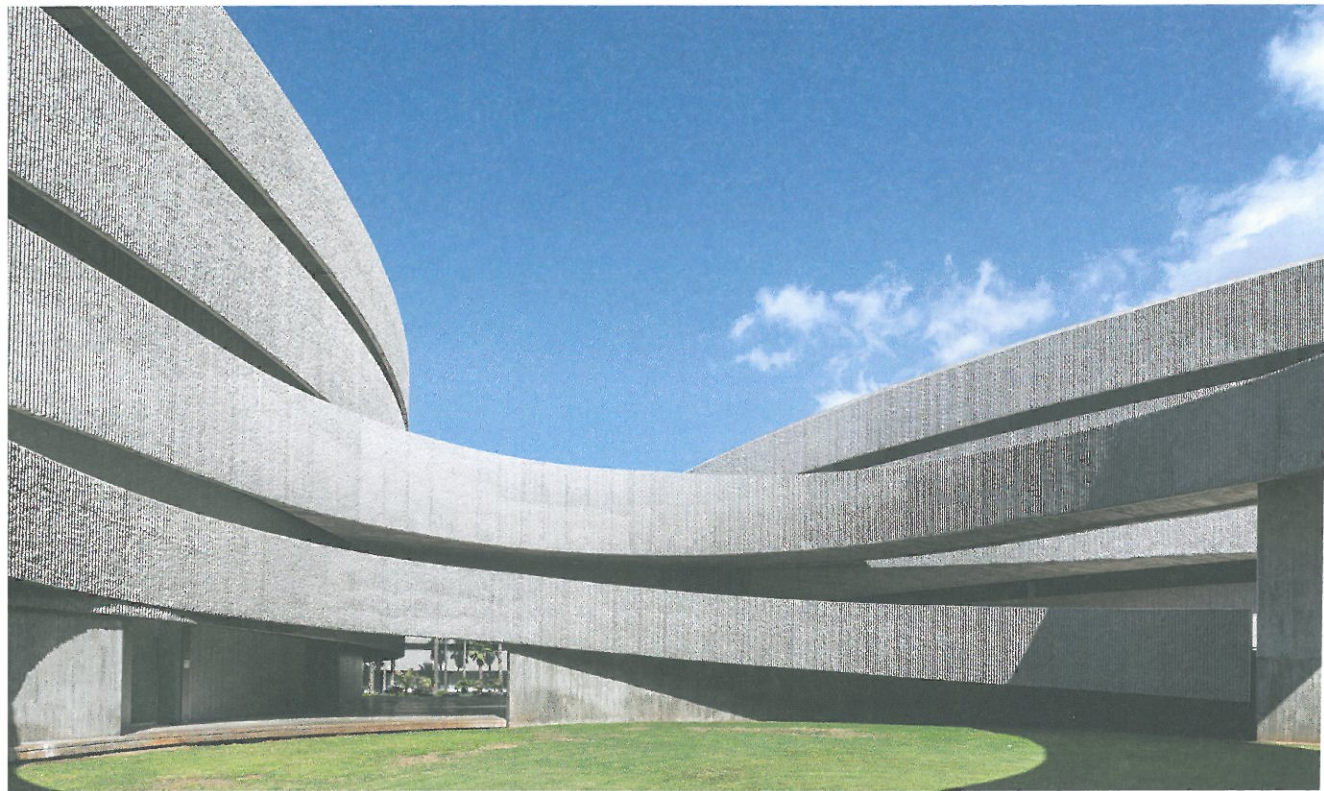

Patio with central ramp



Atelier

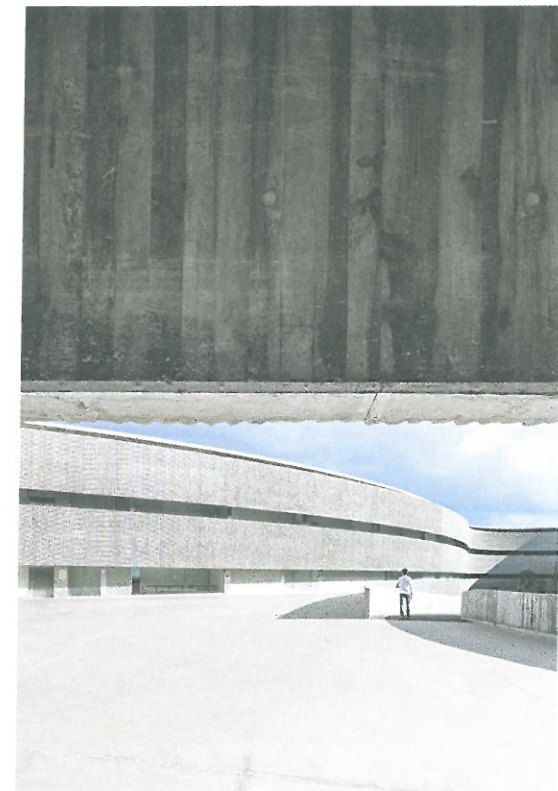

Terrace as open corridor



Entrance terrace



Interior patio

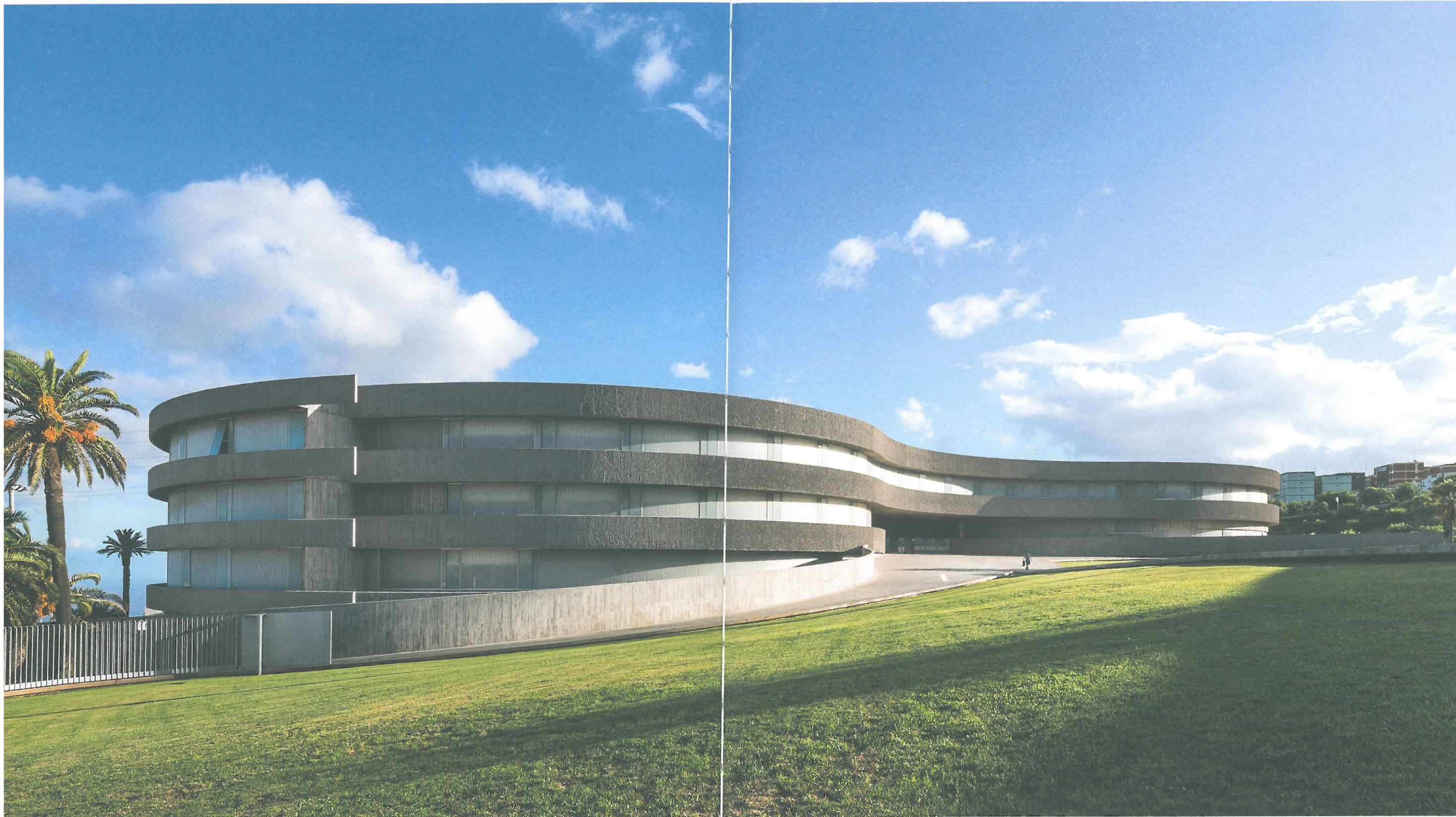

Public plaza and main entrance

Imprint

The Deutsche Nationalbibliothek lists this publication in the Deutsche Nationalbibliografie; detailed bibliographic data are available on the Internet at <http://dnb.dnb.de>

ISBN 978-3-03768-224-1

© 2018 by Braun Publishing AG

www.braun-publishing.ch

The work is copyright protected. Any use outside of the close boundaries of the copyright law, which has not been granted permission by the publisher, is unauthorized and liable for prosecution. This especially applies to duplications, translations, micro-filming, and any saving or processing in electronic systems.

1st edition 2018

Editor: Editorial Office van Uffelen

Editorial staff and layout: Susanne Bauer, Lisa Rogers, Georgia van Uffelen, Celine Zaiser

Graphic concept: Ultrapaper – creative Studio

Reproduction: Bild1Druck GmbH, Berlin

All of the information in this volume has been compiled to the best of the editor's knowledge. It is based on the information provided to the publisher by the architects' and designers' offices and excludes any liability. The publisher assumes no responsibility for its accuracy or completeness as well as copyright discrepancies and refers to the specified sources (architects' and designers' offices). All rights to the photographs are property of the photographer (please refer to the picture credits).

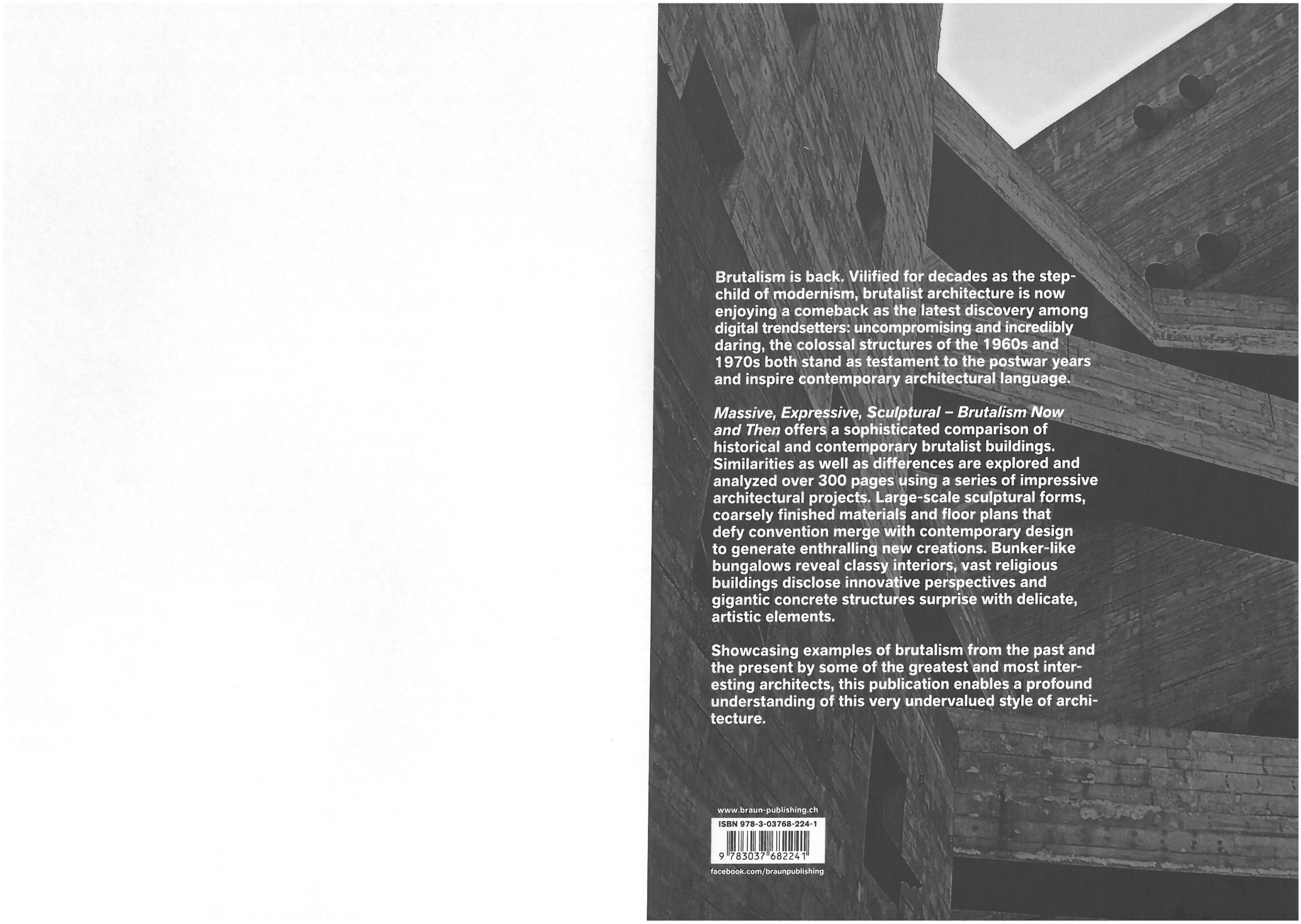

Brutalism is back. Vilified for decades as the step-child of modernism, brutalist architecture is now enjoying a comeback as the latest discovery among digital trendsetters: uncompromising and incredibly daring, the colossal structures of the 1960s and 1970s both stand as testament to the postwar years and inspire contemporary architectural language.

***Massive, Expressive, Sculptural – Brutalism Now and Then* offers a sophisticated comparison of historical and contemporary brutalist buildings. Similarities as well as differences are explored and analyzed over 300 pages using a series of impressive architectural projects. Large-scale sculptural forms, coarsely finished materials and floor plans that defy convention merge with contemporary design to generate enthralling new creations. Bunker-like bungalows reveal classy interiors, vast religious buildings disclose innovative perspectives and gigantic concrete structures surprise with delicate, artistic elements.**

Showcasing examples of brutalism from the past and the present by some of the greatest and most interesting architects, this publication enables a profound understanding of this very undervalued style of architecture.

www.braun-publishing.ch

ISBN 978-3-03768-224-1



9 783037 682241

facebook.com/braunpublishing